

OFFICE LEASE LOCATION

1801 1ST AVE
LONGVIEW, WA 98632
4TH FLOOR SUITES

PER
MONTH

\$ **650-850**

SUITE
SIZES

SF
175-217



ABOUT THE PROPERTY

Multiple single office suites available for lease in this optimally located and well cared for office condo. The River Suites boast good visibility with views of the Cowlitz River and surrounding areas. Available Suites located on the fourth floor and served by an elevator. Suites range in size from 175-208 SF. This location is move-in ready, and features a lobby/waiting area, shared restrooms, and excellent parking. Asking lease rates range from \$650-\$850 per month and include utilities and Wi-Fi. Don't miss out on a great deal, call today for your private tour.

PROPERTY DETAIL

Room 1 | \$850/Month | 217 SF +/-
 Room 5 | \$800/Month | 175 SF +/-
 Room 6 | \$650/Month | 208 SF +/-
 Room 7 | \$650/Month | 183 SF +/-
 Room 8 | \$700/Month | 195 SF +/-
 Room 8 | \$800/Month | *Plus Reception Area*

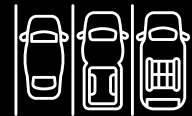

AMPLE
PARKING

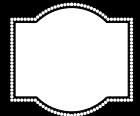

EXCELLENT
SIGNAGE



woodfordcre.com



chris@woodfordcre.com

GET IN TOUCH

Chris Roewe
Owner/Broker

Lindsay Johnson
Licensed Assistant



(360) 501-5500



lindsay@woodfordcre.com

FLOOR PLAN | FOURTH FLOOR

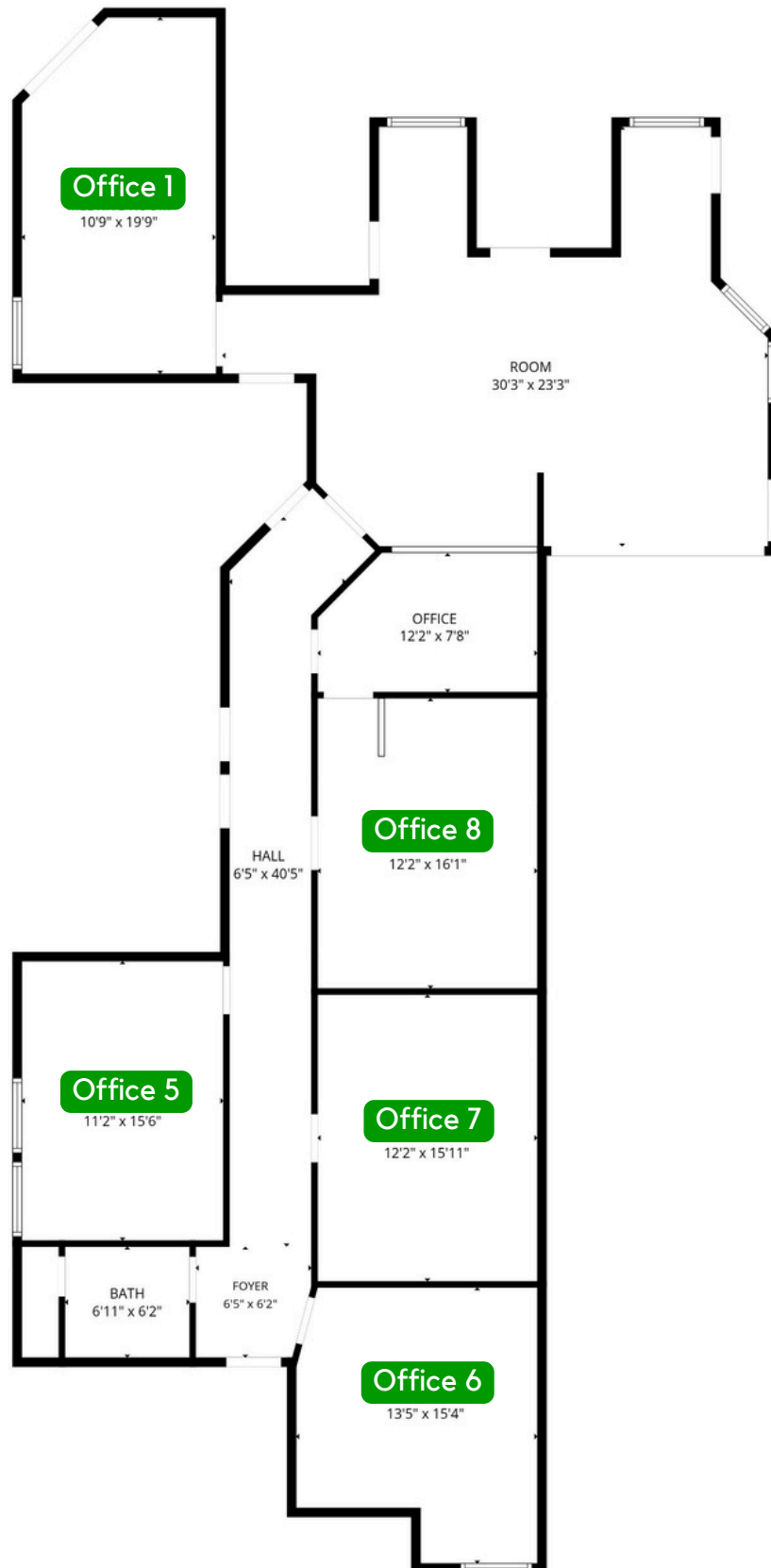

The information contained herein has been obtained from sources we understand to be reliable. Whilst we do not doubt its accuracy it has not been verified & we make no guarantees, warranty or representations about it. Any projections, opinions, assumptions or estimates used are for example only. You & your advisors should conduct a careful independent investigation of the property to determine the property's satisfaction to your needs. © Woodford Commercial Real Estate.



PHOTOS

